

A0 scara 1:500

Proprietari:  
SC EMERALD TOWERS SRL  
SC SAPPHIRE TOWERS SRL  
SC VICTORY TOWERS SRL

JUd. BRASOV  
TERIT. ADM. BRASOV

PLAN TOPOGRAFIC  
Nr. cad. 104277 inscris in CF Nr. 104277 Brasov  
Nr. cad. 104266 inscris in CF Nr. 104266 Brasov  
Nr.top. 4196, 4197/a/1 inscris in CF Nr. 100521 Brasov  
SCARA 1:500

NOTA:  
Sistem de proiectie stereografica  
Plan de referinta Marca Neagra

No. Pkt.	Coordonate pct de control	
	X [m]	Y [m]
870	459322.870	459613.440
871	459322.960	459620.390
872	459322.140	459602.140
873	459311.488	459598.173
874	459313.040	459598.700
875	459300.240	459598.480
876	459304.180	459598.200
877	459300.800	459598.120
878	459303.711	459601.121
879	459300.210	459598.080
880	459296.990	459598.140
881	459291.790	459598.080
882	459291.540	459592.370
883	459291.630	459597.288
884	459293.300	459620.488
885	459296.300	459620.240
886	459290.200	459624.630
887	459296.470	459616.110
888	459290.520	459620.640
889	459291.620	459614.270
890	459292.107	459614.300
891	459292.209	459617.300
892	459296.624	459615.200
893	459291.010	459616.800
894	459291.707	459616.640
895	459291.850	459616.463
896	459293.170	459618.830
897	459293.480	459619.840
898	459290.200	459619.130
899	459291.810	459618.640
900	459291.007	459619.724
901	459290.700	459624.241
902	459290.680	459619.861
903	459290.680	459619.861
904	459294.304	459619.248
905	459294.304	459619.248
906	459294.304	459619.248
907	459294.304	459619.248
908	459294.304	459619.248
909	459294.304	459619.248
910	459294.304	459619.248
911	459294.304	459619.248
912	459294.304	459619.248
913	459294.304	459619.248
914	459294.304	459619.248
915	459294.304	459619.248
916	459294.304	459619.248
917	459294.304	459619.248
918	459294.304	459619.248
919	459294.304	459619.248
920	459294.304	459619.248
921	459294.304	459619.248
922	459294.304	459619.248
923	459294.304	459619.248
924	459294.304	459619.248
925	459294.304	459619.248
926	459294.304	459619.248
927	459294.304	459619.248
928	459294.304	459619.248
929	459294.304	459619.248
930	459294.304	459619.248
931	459294.304	459619.248
932	459294.304	459619.248
933	459294.304	459619.248
934	459294.304	459619.248
935	459294.304	459619.248
936	459294.304	459619.248
937	459294.304	459619.248
938	459294.304	459619.248
939	459294.304	459619.248
940	459294.304	459619.248
941	459294.304	459619.248
942	459294.304	459619.248
943	459294.304	459619.248
944	459294.304	459619.248
945	459294.304	459619.248
946	459294.304	459619.248
947	459294.304	459619.248
948	459294.304	459619.248
949	459294.304	459619.248
950	459294.304	459619.248
951	459294.304	459619.248
952	459294.304	459619.248
953	459294.304	459619.248
954	459294.304	459619.248
955	459294.304	459619.248
956	459294.304	459619.248
957	459294.304	459619.248
958	459294.304	459619.248
959	459294.304	459619.248
960	459294.304	459619.248
961	459294.304	459619.248
962	459294.304	459619.248
963	459294.304	459619.248
964	459294.304	459619.248
965	459294.304	459619.248
966	459294.304	459619.248
967	459294.304	459619.248
968	459294.304	459619.248
969	459294.304	459619.248
970	459294.304	459619.248
971	459294.304	459619.248
972	459294.304	459619.248
973	459294.304	459619.248
974	459294.304	459619.248
975	459294.304	459619.248
976	459294.304	459619.248
977	459294.304	459619.248
978	459294.304	459619.248
979	459294.304	459619.248
980	459294.304	459619.248
981	459294.304	459619.248
982	459294.304	459619.248
983	459294.304	459619.248
984	459294.304	459619.248
985	459294.304	459619.248
986	459294.304	459619.248
987	459294.304	459619.248
988	459294.304	459619.248
989	459294.304	459619.248
990	459294.304	459619.248
991	459294.304	459619.248
992	459294.304	459619.248
993	459294.304	459619.248
994	459294.304	459619.248
995	459294.304	459619.248
996	459294.304	459619.248
997	459294.304	459619.248
998	459294.304	459619.248
999	459294.304	459619.248
1000	459294.304	459619.248

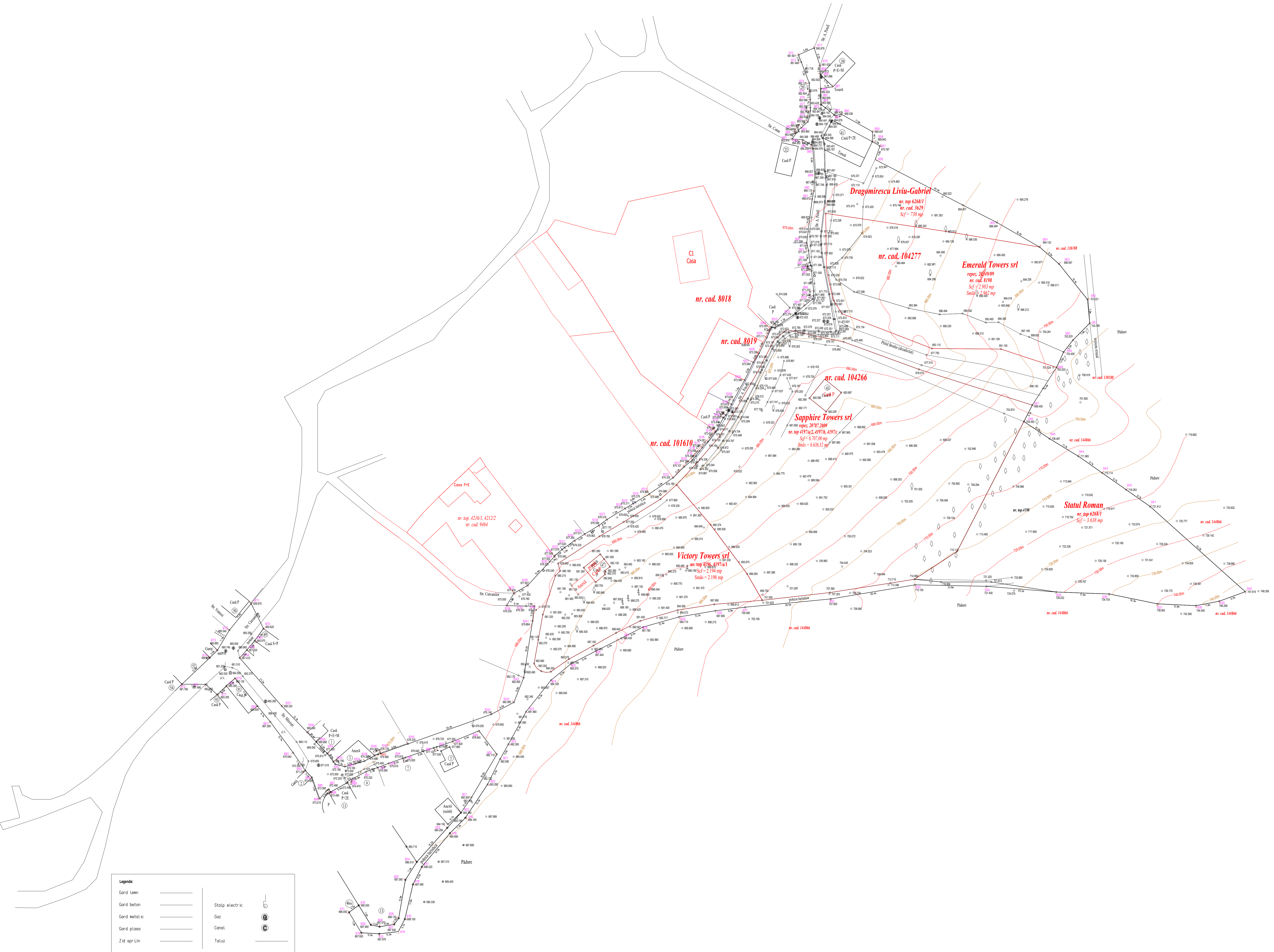

**Legende:**

Gard lemn	Stalp electric		
Gard beton	Gez		
Gard metalic	Canal		
Gard plasa	Taliz		
Zid spr./in			

Stampa profesionala  
  
 Receptionat  
 LECA CORNELIA  
 Semnatura

Intocmit:  
Ing. Mosoiu Ovidiu  
Data: 23.09.2016

Urbanism		Parafa		Stampa profesionala	
Verificator/Expert:	Centru:	Seminarul nr. / Data:		Proiect nr.:	
SC ARI CONSULT SRL	SC SAPPHIRE TOWERS SRL			16_2306	
Str. 15 NOIEMBRIE NR. 96, SC. C. AP. 5, BRASOV	LOCUINTE COLECTIVE				
Desenat: ARH. RAZVAN DRACEA	Adresa: Str. Pictor Sandor, Nr. 43-45, Brasov				P.U.Z.
Verificat: ARH. RAZVAN DRACEA	Data: 09.2017				Planşa:
					TOPO